

Pitch: 7.50mm(0.295inch)

- **Description :**
- Pitch : 7.50mm (0.295inch)

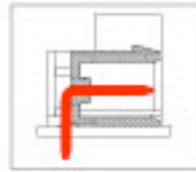



SPECIFICATIONS

			CUL
負載電壓	Rated Voltage	Bemessungsspannung	300V
負載電流	Rated Current	Bemessungsstrom	16A
塑膠本體	Housing Material	Isolierstofftyp	Polyamide66(UL94V-0)
焊針	Solder Pin	Lötstift	□1.0mm, Brass, Tin plated
操作溫度	Operating Temperature	Umgebungstemperatur	-40°C to + 105°C
PC板孔徑	PCB Hole Diameter	Lochdurchmesser	φ1.7mm
UL File No.	E167040		

TABLE

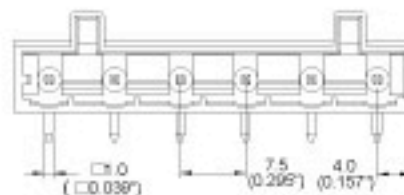
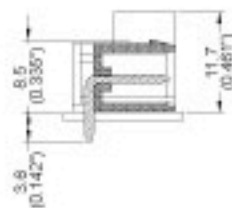
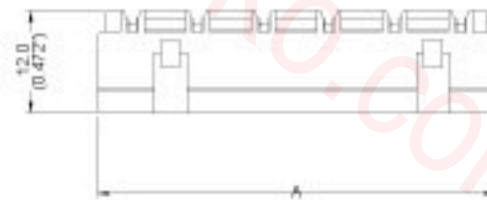
Item No.	A(mm)	A(inch)
ME735-75002	15.50	0.610
ME735-75003	23.00	0.906
ME735-75004	30.50	1.201
ME735-75005	38.00	1.496
ME735-75006	45.50	1.791
ME735-75007	53.00	2.087
ME735-75008	60.50	2.382
ME735-75009	68.00	2.677
ME735-75010	75.50	2.972
ME735-75011	83.00	3.268
ME735-75012	90.50	3.563
ME735-75013	98.00	3.858
ME735-75014	105.50	4.154
ME735-75015	113.00	4.449
ME735-75016	120.50	4.744
ME735-75017	128.22	5.039
ME735-75018	135.50	5.335
ME735-75019	143.00	5.630
ME735-75020	150.50	5.925
ME735-75021	158.00	6.220
ME735-75022	165.50	6.516



PCB Layout



Pitch: 7.62mm(0.300inch)

- **Description :**
- Pitch : 7.62mm (0.300inch)

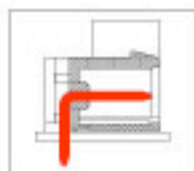



SPECIFICATIONS

負載電壓	Rated Voltage	Bemessungsspannung	CUL
負載電流	Rated Current	Bemessungsstrom	16A
塑膠本體	Housing Material	Isolierstofftyp	Polyamide66(UL94V-0)
焊針	Solder Pin	Lötstift	□ 1.0mm, Brass, Tin plated
操作溫度	Operating Temperature	Umgebungstemperatur	-40°C to + 105°C
PC板孔徑	PCB Hole Diameter	Lochdurchmesser	φ 1.7 mm
UL File No.	E167040		

TABLE

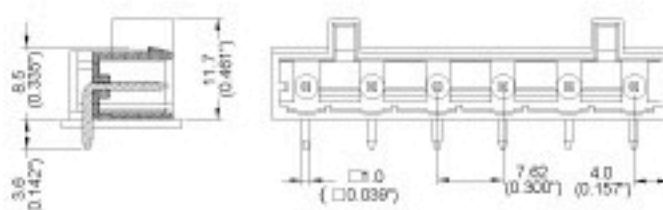
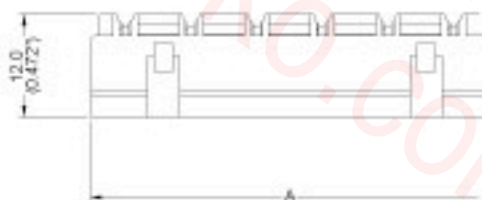
Item No.	A(mm)	A(inch)
ME735-76202	15.62	0.615
ME735-76203	23.24	0.915
ME735-76204	30.86	1.215
ME735-76205	38.84	1.515
ME735-76206	46.10	1.815
ME735-76207	53.72	2.115
ME735-76208	61.34	2.415
ME735-76209	68.96	2.715
ME735-76210	76.58	3.015
ME735-76211	84.20	3.315
ME735-76212	91.82	3.615
ME735-76213	99.44	3.915
ME735-76214	107.06	4.215
ME735-76215	114.68	4.515
ME735-76216	122.30	4.815
ME735-76217	129.92	5.115
ME735-76218	137.54	5.415
ME735-76219	145.16	5.715
ME735-76220	152.78	6.015
ME735-76221	160.40	6.315
ME735-76222	168.02	6.615



PCB Layout

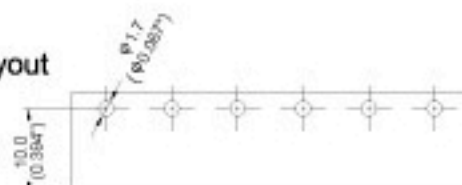

Pitch: 2.50mm(0.150inch)

- Description :
- Pitch : 2.50mm (0.150inch)

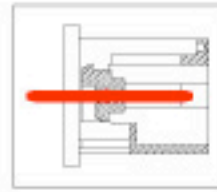



SPECIFICATIONS

		CUL	
負載電壓	Rated Voltage	Bemessungsspannung	AC 150V
負載電流	Rated Current	Bemessungsstrom	4A
塑膠本體	Housing Material	Isolierstofftyp	Polyamide66(UL94V-0)
焊針	Solder Pin	Lötstift	□0.8mm, Brass, Tin plated
操作溫度	Operating Temperature	Umgebungstemperatur	-40°C to + 105°C
PC板孔徑	PCB Hole Diameter	Lochdurchmesser	φ1.4 mm
UL File No.	E167040		

TABLE

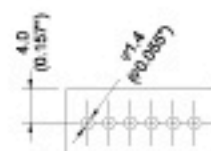
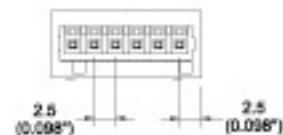
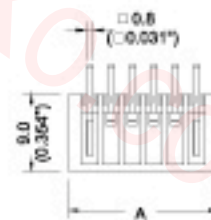
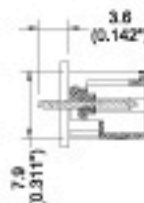
Item No.	A(mm)	A(inch)
ME740-25002	7.50	0.295
ME740-25003	10.00	0.394
ME740-25004	12.50	0.492
ME740-25005	15.00	0.591
ME740-25006	17.50	0.689
ME740-25007	20.00	0.787
ME740-25008	22.50	0.886
ME740-25009	25.00	0.984
ME740-25010	27.50	1.083
ME740-25011	30.00	1.181
ME740-25012	32.50	1.280
ME740-25013	35.00	1.378
ME740-25014	37.50	1.48
ME740-25015	40.00	1.575
ME740-25016	42.50	1.673
ME740-25017	45.00	1.772
ME740-25018	47.50	1.870
ME740-25019	50.00	1.969
ME740-25020	52.50	2.067
ME740-25021	55.00	2.165
ME740-25022	57.50	2.264
ME740-25023	60.00	2.362
ME740-25024	62.50	2.461



PCB Layout

Pitch: 2.54mm(0.100inch)

- Description :
- Pitch : 2.54mm (0.100inch)

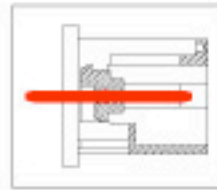
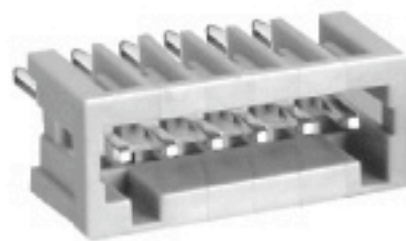
CUL[®] US

SPECIFICATIONS

			CUL
負載電壓	Rated Voltage	Bemessungsspannung	AC 150V
負載電流	Rated Current	Bemessungsstrom	4A
塑膠本體	Housing Material	Isolierstofftyp	Polyamide66(UL94V-0)
焊針	Solder Pin	Lötstift	□0.8mm, Brass, Tin plated
操作溫度	Operating Temperature	Umgebungstemperatur	-40°C to + 105°C
PC板孔徑	PCB Hole Diameter	Lochdurchmesser	φ1.4 mm

TABLE

Item No.	A(mm)	A(inch)
ME740-25402	7.54	0.297
ME740-25403	10.08	0.397
ME740-25404	12.62	0.497
ME740-25405	15.16	0.597
ME740-25406	17.70	0.697
ME740-25407	20.24	0.797
ME740-25408	22.78	0.897
ME740-25409	25.32	0.997
ME740-25410	27.86	1.097
ME740-25411	30.40	1.197
ME740-25412	32.94	1.297
ME740-25413	35.48	1.397
ME740-25414	38.02	1.497
ME740-25415	40.56	1.597
ME740-25416	43.10	1.697
ME740-25417	45.64	1.797
ME740-25418	48.18	1.897
ME740-25419	50.72	1.997
ME740-25420	53.26	2.097
ME740-25421	55.80	2.197
ME740-25422	58.34	2.297
ME740-25423	60.88	2.397
ME740-25424	63.42	2.497

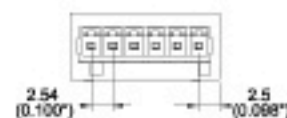
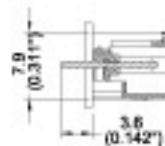
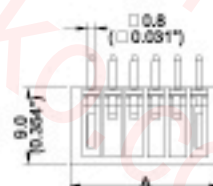

PCB Layout

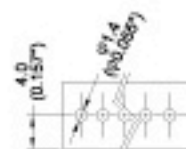

Pitch: 3.50mm(0.138inch)

- Description :
- Pitch : 3.50mm (0.138inch)

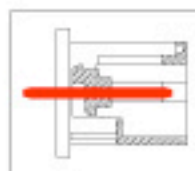
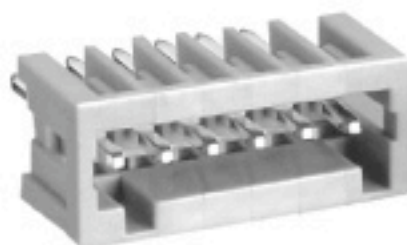



SPECIFICATIONS

		CUL	
負載電壓	Rated Voltage	Bemessungsspannung	AC 300V
負載電流	Rated Current	Bemessungsstrom	10A
塑膠本體	Housing Material	Isolierstofftyp	Polyamide66(UL94V-0)
焊針	Solder Pin	Lötstift	□ 1.0mm, Brass, Tin plated
操作溫度	Operating Temperature	Umgebungstemperatur	-40°C to + 105°C
PC板孔徑	PCB Hole Diameter	Lochdurchmesser	φ 1.7 mm
UL File No.	E167040		

TABLE

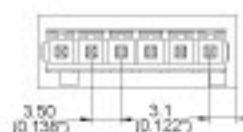
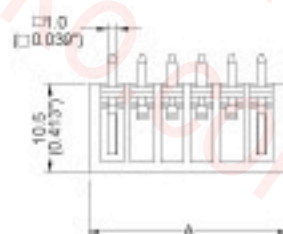
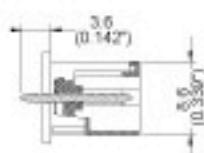
Item No.	A(mm)	A(inch)
ME740-35002	9.45	0.372
ME740-35003	12.95	0.510
ME740-35004	16.45	0.648
ME740-35005	19.95	0.785
ME740-35006	23.45	0.923
ME740-35007	26.95	1.061
ME740-35008	30.45	1.199
ME740-35009	33.95	1.337
ME740-35010	37.45	1.474
ME740-35011	40.95	1.612
ME740-35012	44.45	1.750
ME740-35013	47.95	1.888
ME740-35014	51.45	2.026
ME740-35015	54.95	2.163
ME740-35016	58.45	2.301
ME740-35017	61.95	2.439
ME740-35018	65.45	2.577
ME740-35019	68.95	2.715
ME740-35020	72.45	2.852
ME740-35021	75.95	2.990
ME740-35022	79.45	3.128
ME740-35023	82.95	3.266
ME740-35024	86.45	3.404



PCB Layout

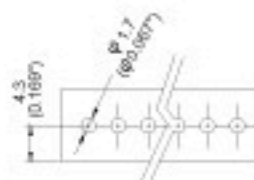

Pitch: 3.81mm(0.150inch)

- Description :
- Pitch : 3.81mm (0.150inch)

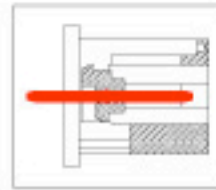
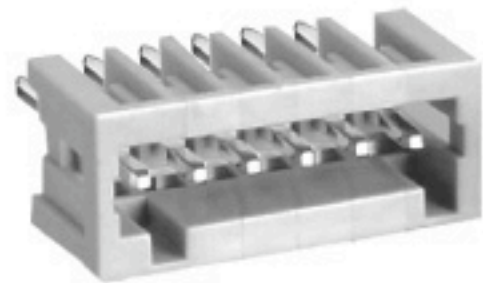



SPECIFICATIONS

			CUL
負載電壓	Rated Voltage	Bemessungsspannung	AC 300V
負載電流	Rated Current	Bemessungsstrom	10A
塑膠本體	Housing Material	Isolierstofftyp	Polyamide66(UL94V-0)
焊針	Solder Pin	Lötstift	□1.0mm, Brass, Tin plated
操作溫度	Operating Temperature	Umgebungstemperatur	-40°C to + 105°C
PC板孔徑	PCB Hole Diameter	Lochdurchmesser	φ1.7mm

TABLE

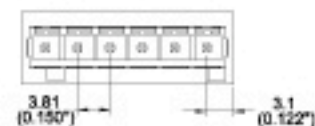
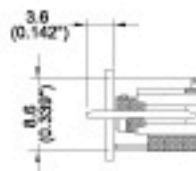
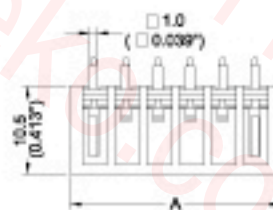
Item No.	A(mm)	A(inch)
ME740-38102	9.73	0.383
ME740-38103	13.54	0.533
ME740-38104	17.35	0.683
ME740-38105	21.16	0.833
ME740-38106	24.97	0.983
ME740-38107	28.78	1.133
ME740-38108	32.59	1.283
ME740-38109	36.40	1.433
ME740-38110	40.21	1.583
ME740-38111	44.02	1.733
ME740-38112	47.83	1.883
ME740-38113	51.64	2.033
ME740-38114	55.45	2.183
ME740-38115	59.26	2.333
ME740-38116	63.07	2.483
ME740-38117	66.88	2.633
ME740-38118	70.69	2.783
ME740-38119	74.50	2.933
ME740-38120	78.31	3.083
ME740-38121	82.12	3.233
ME740-38122	85.93	3.383
ME740-38123	89.74	3.533
ME740-38124	93.55	3.683



PCB Layout

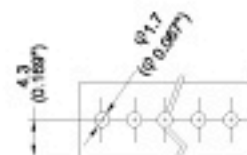

Pitch: 5.00mm(0.197inch)

- Description :
- Pitch : 5.00mm (0.197inch)

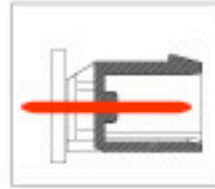
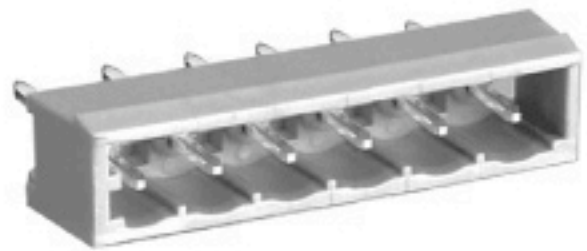
C  US

SPECIFICATIONS

負載電壓	Rated Voltage	Bemessungsspannung	CUL AC 300V
負載電流	Rated Current	Bemessungsstrom	16A
塑膠本體	Housing Material	Isolierstofftyp	Polyamide66(UL94V-0)
焊針	Solder Pin	Lötstift	□1.0mm, Brass, Tin plated
操作溫度	Operating Temperature	Umgebungstemperatur	-40°C to + 105°C
PC板孔徑	PCB Hole Diameter	Lochdurchmesser	φ1.7mm

TABLE

Item No.	A(mm)	A(inch)
ME740-50002	13.2	0.523
ME745-50003	18.3	0.723
ME740-50004	23.4	0.923
ME740-50005	28.5	1.123
ME740-50006	33.6	1.323
ME740-50007	38.6	1.523
ME740-50008	43.7	1.723
ME740-50009	48.8	1.923
ME740-50010	53.9	2.123
ME740-50011	59.0	2.323
ME740-50012	64.0	2.523
ME740-50013	69.1	2.723
ME740-50014	74.2	2.923
ME740-50015	79.3	3.123
ME740-50016	84.4	3.323
ME740-50017	89.4	3.523
ME740-50018	94.5	3.723
ME740-50019	99.6	3.923
ME740-50020	104.7	4.123
ME740-50021	109.8	4.323
ME740-50022	114.8	4.523
ME740-50023	119.9	4.723
ME740-50024	125.0	4.923

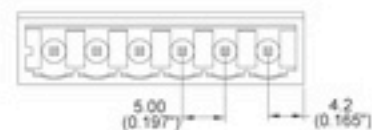
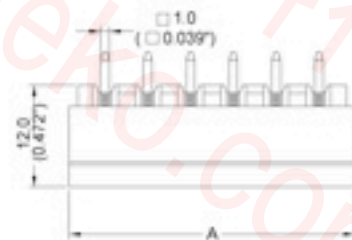
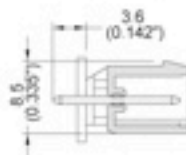

PCB Layout

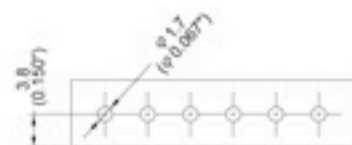

Pitch: 5.08mm(0.200inch)

- **Description :**
- Pitch : 5.08mm (0.200inch)

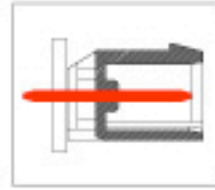
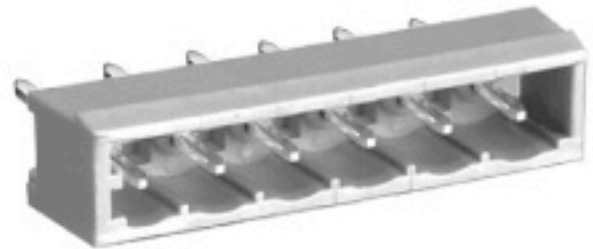



SPECIFICATIONS

			CUL
負載電壓	Rated Voltage	Bemessungsspannung	AC 300V
負載電流	Rated Current	Bemessungsstrom	16A
塑膠本體	Housing Material	Isolierstofftyp	Polyamide66(UL94V-0)
焊針	Solder Pin	Lötstift	□1.0mm, Brass, Tin plated
操作溫度	Operating Temperature	Umgebungstemperatur	-40°C to + 105°C
PC板孔徑	PCB Hole Diameter	Lochdurchmesser	φ1.7mm

TABLE

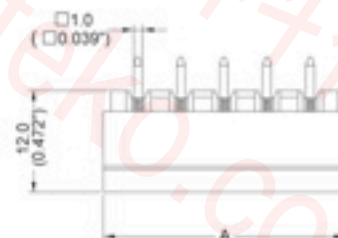
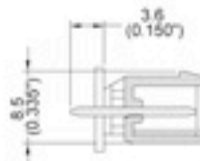
Item No.	A(mm)	A(inch)
ME740-50802	13.4	0.528
ME740-50803	18.4	0.724
ME740-50804	23.4	0.921
ME740-50805	28.4	1.118
ME740-50806	33.4	1.315
ME740-50807	38.4	1.512
ME740-50808	43.4	1.709
ME740-50809	48.4	1.906
ME740-50810	53.4	2.102
ME740-50811	58.4	2.299
ME740-50812	63.4	2.496
ME740-50813	68.4	2.693
ME740-50814	73.4	2.890
ME740-50815	78.4	3.087
ME740-50816	83.4	3.283
ME740-50817	88.4	3.480
ME740-50818	93.4	3.677
ME740-50819	98.4	3.874
ME740-50820	103.4	4.071
ME740-50821	108.4	4.268
ME740-50822	113.4	4.465
ME740-50823	118.4	4.661
ME740-50824	123.4	4.858



PCB Layout

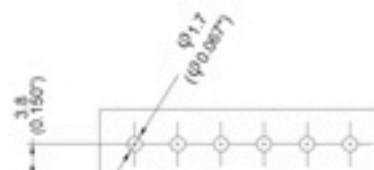

Pitch: 7.50mm(0.295inch)

- Description :
- Pitch : 7.50mm (0.295inch)

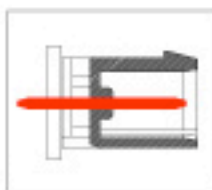



SPECIFICATIONS

			CUL
負載電壓	Rated Voltage	Bemessungsspannung	AC 300V
負載電流	Rated Current	Bemessungsstrom	16A
塑膠本體	Housing Material	Isolierstofftyp	Polyamide66(UL94V-0)
焊針	Solder Pin	Lötstift	□1.0mm, Brass, Tin plated
操作溫度	Operating Temperature	Umgebungstemperatur	-40°C to + 105°C
PC板孔徑	PCB Hole Diameter	Lochdurchmesser	φ1.7mm

TABLE

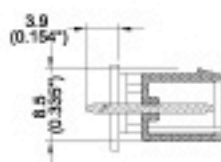
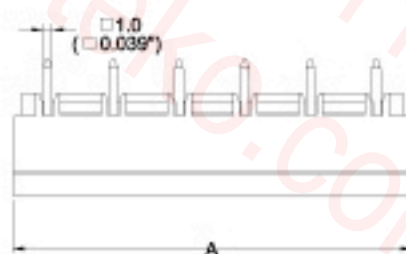
Item No.	A(mm)	A(inch)
ME740-75002	15.50	0.610
ME740-75003	23.00	0.906
ME740-75004	30.50	1.201
ME740-75005	38.00	1.496
ME740-75006	45.50	1.791
ME740-75007	53.00	2.087
ME740-75008	60.50	2.382
ME740-75009	68.00	2.677
ME740-75010	75.50	2.972
ME740-75011	83.00	3.268
ME740-75012	90.50	3.563
ME740-75013	96.00	3.858
ME740-75014	105.50	4.154
ME740-75015	113.00	4.449
ME740-75016	120.50	4.744
ME740-75017	128.22	5.039
ME740-75018	135.50	5.335
ME740-75019	143.00	5.630
ME740-75020	150.50	5.925
ME740-75021	158.00	6.220
ME740-75022	165.50	6.516



PCB Layout

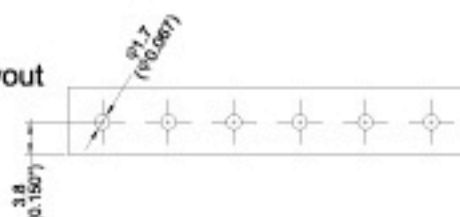

Pitch: 7.62mm(0.300inch)

- **Description :**
- Pitch : 7.62mm (0.300inch)

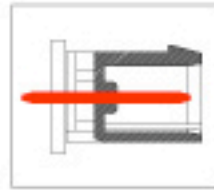



SPECIFICATIONS

			CUL
負載電壓	Rated Voltage	Bemessungsspannung	AC 300V
負載電流	Rated Current	Bemessungsstrom	16A
塑膠本體	Housing Material	Isolierstofftyp	Polyamide66(UL94V-0)
焊針	Solder Pin	Lötstift	□ 1.0mm, Brass, Tin plated
操作溫度	Operating Temperature	Umgebungstemperatur	-40°C to + 105°C
PC板孔徑	PCB Hole Diameter	Lochdurchmesser	φ1.7mm

TABLE

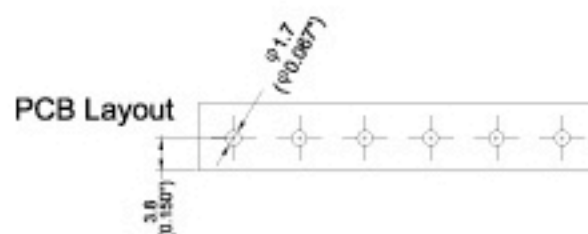
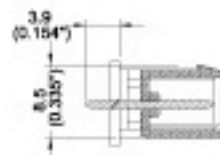
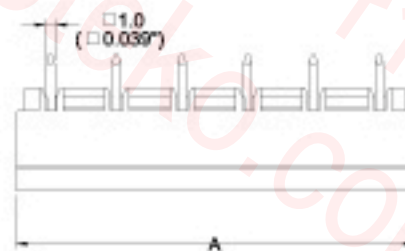
Item No.	A(mm)	A(inch)
ME740-76202	15.62	0.615
ME740-76203	23.24	0.915
ME740-76204	30.86	1.215
ME740-76205	38.84	1.515
ME740-76206	46.10	1.815
ME740-76207	53.72	2.115
ME740-76208	61.34	2.415
ME740-76209	68.96	2.715
ME740-76210	76.58	3.015
ME740-76211	84.20	3.315
ME740-76212	91.82	3.615
ME740-76213	99.44	3.915
ME740-76214	107.06	4.215
ME740-76215	114.68	4.515
ME740-76216	122.30	4.815
ME740-76217	129.92	5.115
ME740-76218	137.54	5.415
ME740-76219	145.16	5.715
ME740-76220	152.78	6.015
ME740-76221	160.40	6.315
ME740-76222	168.02	6.615



Pitch: 5.00mm(0.197inch)

- Description :
- Pitch : 5.00mm (0.197inch)

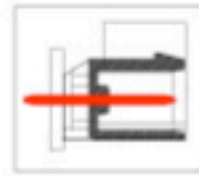



SPECIFICATIONS

		CUL	
負載電壓	Rated Voltage	Bemessungsspannung	AC 300V
負載電流	Rated Current	Bemessungsstrom	16A
塑膠本體	Housing Material	Isolierstofftyp	Polyamide66(UL94V-0)
焊針	Solder Pin	Lötstift	□ 1.0mm, Brass, Tin plated
操作溫度	Operating Temperature	Umgebungstemperatur	-40°C to + 105°C
PC板孔徑	PCB Hole Diameter	Lochdurchmesser	φ1.8mm
UL File No.	E167040		

TABLE

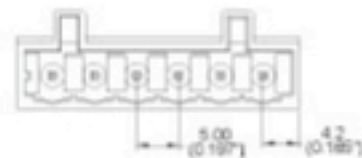
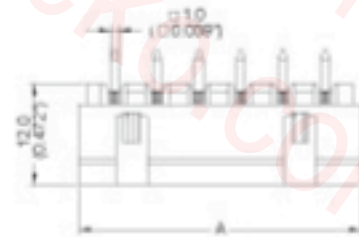
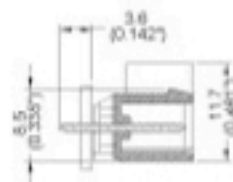
Item No.	A(mm)	A(inch)
ME745-50002	13.2	0.523
ME745-50003	18.3	0.723
ME745-50004	23.4	0.923
ME745-50005	28.5	1.123
ME745-50006	33.6	1.323
ME745-50007	38.6	1.523
ME745-50008	43.7	1.723
ME745-50009	48.8	1.923
ME745-50010	53.9	2.123
ME745-50011	59.0	2.323
ME745-50012	64.0	2.523
ME745-50013	69.1	2.723
ME745-50014	74.2	2.923
ME745-50015	79.3	3.123
ME745-50016	84.4	3.323
ME745-50017	89.4	3.523
ME745-50018	94.5	3.723
ME745-50019	99.6	3.923
ME745-50020	104.7	4.123
ME745-50021	109.8	4.323
ME745-50022	114.8	4.523
ME745-50023	119.9	4.723
ME745-50024	125.0	4.923



PCB Layout

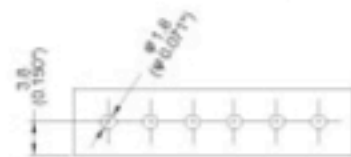

Pitch: 5.08mm(0.200inch)

- **Description :**
- Pitch : 5.08mm (0.200inch)

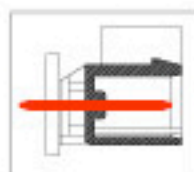



SPECIFICATIONS

			CUL
負載電壓	Rated Voltage	Bemessungsspannung	AC 300V
負載電流	Rated Current	Bemessungsstrom	16 A
塑膠本體	Housing Material	Isolierstofftyp	Polyamide66(UL94V-0)
焊針	Solder Pin	Lötstift	□1.0mm, Brass, Tin plated
操作溫度	Operating Temperature	Umgebungstemperatur	-40°C to + 105°C
PC板孔徑	PCB Hole Diameter	Lochdurchmesser	φ1.8mm
UL File No.	E167040		

TABLE

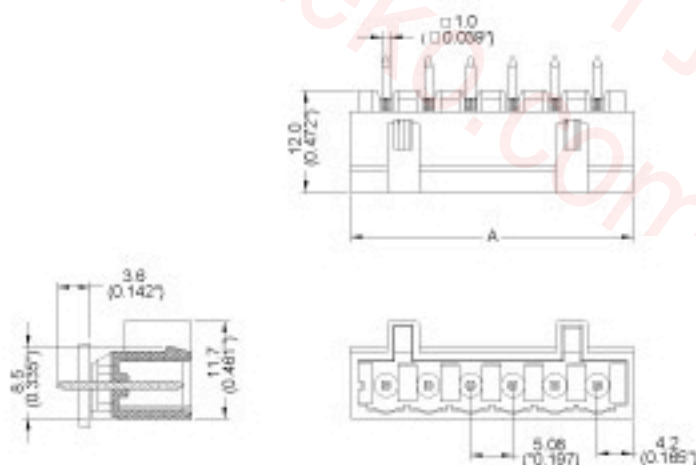
Item No.	A(mm)	A(inch)
ME745-50802	13.4	0.528
ME745-50803	18.4	0.724
ME745-50804	23.4	0.921
ME745-50805	28.4	1.118
ME745-50806	33.4	1.315
ME745-50807	38.4	1.512
ME745-50808	43.4	1.709
ME745-50809	48.4	1.906
ME745-50810	53.4	2.102
ME745-50811	58.4	2.299
ME745-50812	63.4	2.496
ME745-50813	68.4	2.693
ME745-50814	73.4	2.890
ME745-50815	78.4	3.087
ME745-50816	83.4	3.283
ME745-50817	88.4	3.480
ME745-50818	93.4	3.677
ME745-50819	98.4	3.874
ME745-50820	103.4	4.071
ME745-50821	108.4	4.268
ME745-50822	113.4	4.465
ME745-50823	118.4	4.661
ME745-50824	123.4	4.858



PCB Layout

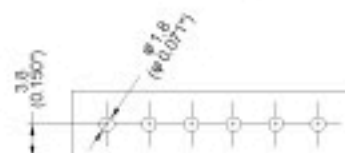

Pitch: 7.50mm(0.295inch)

- Description :
- Pitch : 7.50mm (0.295inch)

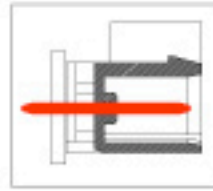
CUL[®] US

SPECIFICATIONS

			CUL
負載電壓	Rated Voltage	Bemessungsspannung	300V
負載電流	Rated Current	Bemessungsstrom	16A
塑膠本體	Housing Material	Isolierstofftyp	Polyamide66(UL94V-0)
焊針	Solder Pin	Lötstift	□1.0mm, Brass, Tin plated
操作溫度	Operating Temperature	Umgebungstemperatur	-40°C to + 105°C
PC板孔徑	PCB Hole Diameter	Lochdurchmesser	φ1.7mm

TABLE

Item No.	A(mm)	A(inch)
ME745-75002	15.50	0.610
ME745-75003	23.00	0.906
ME745-75004	30.50	1.201
ME745-75005	38.00	1.496
ME745-75006	45.50	1.791
ME745-75007	53.00	2.087
ME745-75008	60.50	2.382
ME745-75009	68.00	2.677
ME745-75010	75.50	2.972
ME745-75011	83.00	3.268
ME745-75012	90.50	3.563
ME745-75013	98.00	3.858
ME745-75014	105.50	4.154
ME745-75015	113.00	4.449
ME745-75016	120.50	4.744
ME745-75017	128.00	5.039
ME745-75018	135.50	5.335
ME745-75019	143.00	5.630
ME745-75020	150.50	5.925
ME745-75021	158.00	6.220
ME745-75022	165.50	6.516

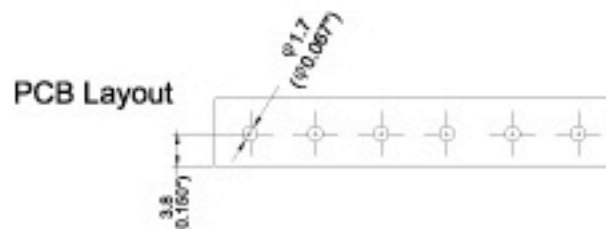
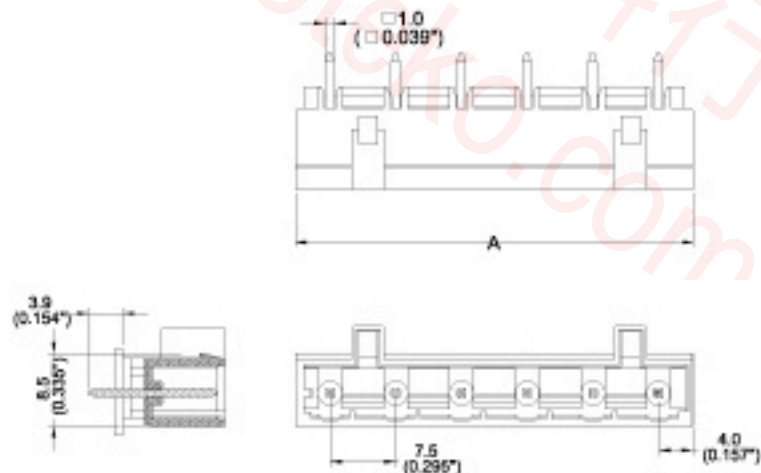

Pitch: 7.62mm(0.300inch)

- Description :
- Pitch : 7.62mm (0.300inch)

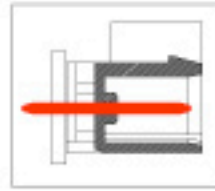
CUL[®] US

SPECIFICATIONS

			CUL
負載電壓	Rated Voltage	Bemessungsspannung	AC300V
負載電流	Rated Current	Bemessungsstrom	16A
塑膠本體	Housing Material	Isolierstofftyp	Polyamide66(UL94V-0)
焊針	Solder Pin	Lötstift	□ 1.0mm, Brass, Tin plated
操作溫度	Operating Temperature	Umgebungstemperatur	-40°C to + 105°C
PC板孔徑	PCB Hole Diameter	Lochdurchmesser	φ 1.7mm

TABLE

Item No.	A(mm)	A(inch)
ME745-76202	15.62	0.615
ME745-76203	23.24	0.915
ME745-76204	30.86	1.215
ME745-76205	38.84	1.515
ME745-76206	46.10	1.815
ME745-76207	53.72	2.115
ME745-76208	61.34	2.415
ME745-76209	68.96	2.715
ME745-76210	76.58	3.015
ME745-76211	84.20	3.315
ME745-76212	91.82	3.615
ME745-76213	99.44	3.915
ME745-76214	107.06	4.215
ME745-76215	114.68	4.515
ME745-76216	122.30	4.815
ME745-76217	129.92	5.115
ME745-76218	137.54	5.415
ME745-76219	145.16	5.715
ME745-76220	152.78	6.015
ME745-76221	160.40	6.315
ME745-76222	168.02	6.615

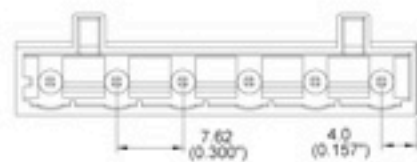
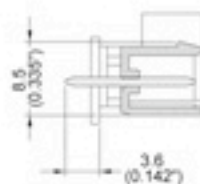
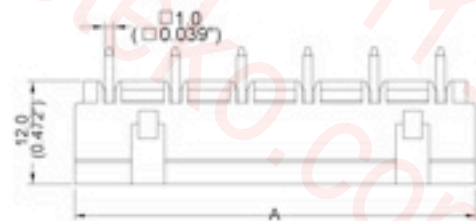

PCB Layout

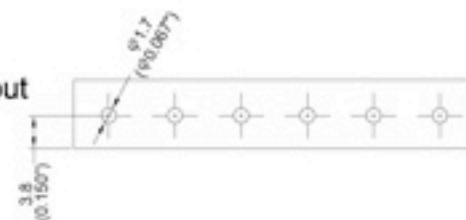

Pitch: 3.50mm(0.138inch)

- Description :
- Pitch : 3.50mm (0.138inch)

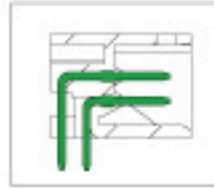



SPECIFICATIONS

		CUL	
負載電壓	Rated Voltage	Bemessungsspannung	AC 150V
負載電流	Rated Current	Bemessungsstrom	5A
塑膠本體	Housing Material	Isolierstofftyp	Polyamide66(UL94V-0)
焊針	Solder Pin	Lötstift	□0.8mm, Brass, Tin plated
操作溫度	Operating Temperature	Umgebungstemperatur	-40°C to + 105°C
PC板孔徑	PCB Hole Diameter	Lochdurchmesser	φ1.3mm

TABLE

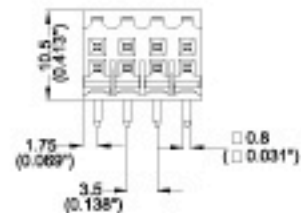
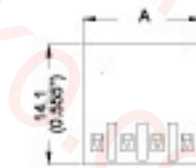
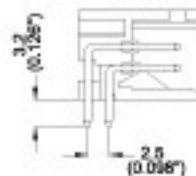
Item No.	A(mm)	A(inch)
ME910-35002	3.5	0.138
ME910-35004	7.0	0.276
ME910-35006	10.5	0.413
ME910-35008	14.0	0.551
ME910-35010	17.5	0.689
ME910-35012	21.0	0.827
ME910-35014	24.5	0.965
ME910-35016	28.0	1.102
ME910-35018	31.5	1.240
ME910-35020	35.0	1.378
ME910-35022	38.5	1.516
ME910-35024	42.0	1.654
ME910-35026	45.5	1.791
ME910-35028	49.0	1.929
ME910-35030	52.5	2.067
ME910-35032	56.0	2.205
ME910-35034	59.5	2.343
ME910-35036	63.0	2.480
ME910-35038	66.5	2.618
ME910-35040	70.0	2.756



PCB Layout

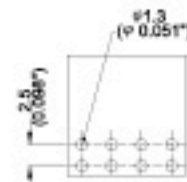

Pitch: 3.50mm(0.138inch)

- Description :
- Pitch : 3.50mm (0.138inch)

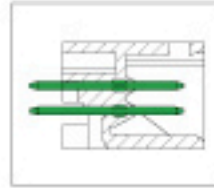



SPECIFICATIONS

			CUL
負載電壓	Rated Voltage	Bemessungsspannung	AC 150V
負載電流	Rated Current	Bemessungsstrom	5A
塑膠本體	Housing Material	Isolierstofftyp	Polyamide66(UL94V-0)
焊針	Solder Pin	Lötstift	□0.8mm, Brass, Tin plated
操作溫度	Operating Temperature	Umgebungstemperatur	-40°C to + 105°C
PC板孔徑	PCB Hole Diameter	Lochdurchmesser	φ1.3mm

TABLE

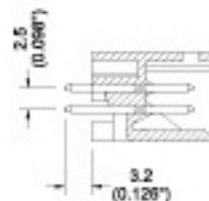
Item No.	A(mm)	A(inch)
ME920-35002	3.5	0.138
ME920-35004	7.0	0.276
ME920-35006	10.5	0.413
ME920-35008	14.0	0.551
ME920-35010	17.5	0.689
ME920-35012	21.0	0.827
ME920-35014	24.5	0.965
ME920-35016	28.0	1.102
ME920-35018	31.5	1.240
ME920-35020	35.0	1.378
ME920-35022	38.5	1.516
ME920-35024	42.0	1.654
ME920-35026	45.5	1.791
ME920-35028	49.0	1.929
ME920-35030	52.5	2.067
ME920-35032	56.0	2.205
ME920-35034	59.5	2.343
ME920-35036	63.0	2.480
ME920-35038	66.5	2.618
ME920-35040	70.0	2.756



PCB Layout

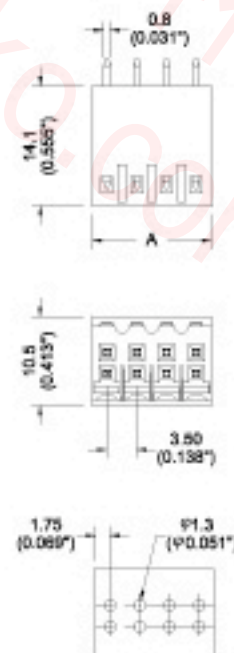

Pitch: 3.50mm(0.138inch)

- **Description :**
- Pitch : 3.50mm (0.138inch)

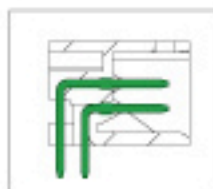



SPECIFICATIONS

			CUL
負載電壓	Rated Voltage	Bemessungsspannung	AC 150V
負載電流	Rated Current	Bemessungsstrom	5A
塑膠本體	Housing Material	Isolierstofftyp	Polyamide66(UL94V-0)
焊針	Solder Pin	Lötstift	□ 0.8mm, Brass, Tin plated
操作溫度	Operating Temperature	Umgebungstemperatur	-40°C to + 105°C
PC板孔徑	PCB Hole Diameter	Lochdurchmesser	φ1.3mm

TABLE

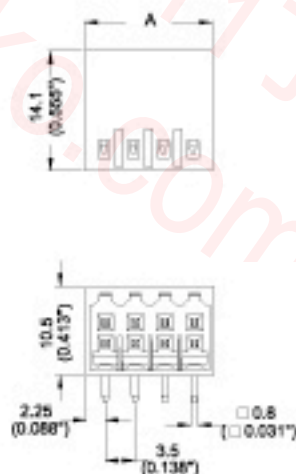
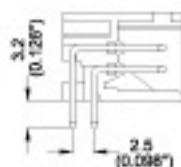
Item No.	A(mm)	A(inch)
ME930-35002	4.5	0.177
ME930-35004	8.0	0.315
ME930-35006	11.5	0.453
ME930-35008	15.0	0.591
ME930-35010	18.5	0.728
ME930-35012	22.0	0.866
ME930-35014	25.5	1.004
ME930-35016	29.0	1.142
ME930-35018	32.5	1.280
ME930-35020	36.0	1.417
ME930-35022	39.5	1.555
ME930-35024	43.0	1.693
ME930-35026	46.5	1.831
ME930-35028	50.0	1.969
ME930-35030	53.5	2.106
ME930-35032	57.0	2.244
ME930-35034	60.5	2.382
ME930-35036	64.0	2.520
ME930-35038	67.5	2.657
ME930-35040	71.0	2.795



PCB Layout

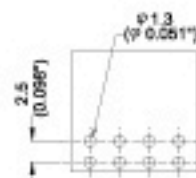

Pitch: 3.50mm(0.138inch)

- **Description :**
- Pitch : 3.50mm (0.138inch)

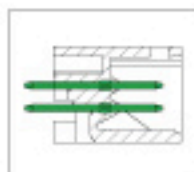



SPECIFICATIONS

			CUL
負載電壓	Rated Voltage	Bemessungsspannung	AC 150V
負載電流	Rated Current	Bemessungsstrom	5A
塑膠本體	Housing Material	Isolierstofftyp	Polyamide66(UL94V-0)
焊針	Solder Pin	Lötstift	□0.8mm, Brass, Tin plated
操作溫度	Operating Temperature	Umgebungstemperatur	-40°C to + 105°C
PC板孔徑	PCB Hole Diameter	Lochdurchmesser	φ1.3mm

TABLE

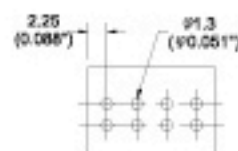
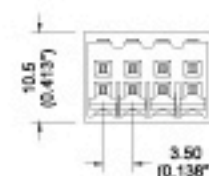
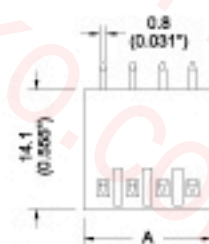
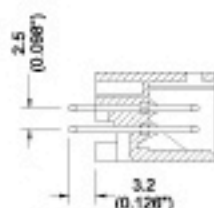
Item No.	A(mm)	A(inch)
ME940-35002	3.5	0.138
ME940-35004	7.0	0.276
ME940-35006	10.5	0.413
ME940-35008	14.0	0.551
ME940-35010	17.5	0.689
ME940-35012	21.0	0.827
ME940-35014	24.5	0.965
ME940-35016	28.0	1.102
ME940-35018	31.5	1.240
ME940-35020	35.0	1.378
ME940-35022	38.5	1.516
ME940-35024	42.0	1.654
ME940-35026	45.5	1.791
ME940-35028	49.0	1.929
ME940-35030	52.5	2.067
ME940-35032	56.0	2.205
ME940-35034	59.5	2.343
ME940-35036	63.0	2.480
ME940-35038	66.5	2.618
ME940-35040	70.0	2.756



PCB Layout

Pitch: 3.50mm(0.138inch)

- **Description :**
- Pitch : 3.50mm (0.138inch)

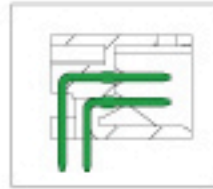



SPECIFICATIONS

負載電壓	Rated Voltage	Bemessungsspannung	CUL	AC 150V
負載電流	Rated Current	Bemessungsstrom		5A
塑膠本體	Housing Material	Isolierstofftyp		Polyamide66(UL94V-0)
焊針	Solder Pin	Lötstift		□0.8mm, Brass, Tin plated
操作溫度	Operating Temperature	Umgebungstemperatur		-40°C to + 105°C
PC板孔徑	PCB Hole Diameter	Lochdurchmesser		φ1.3mm

TABLE

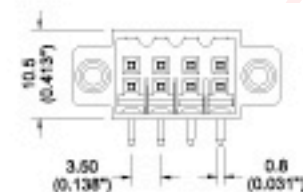
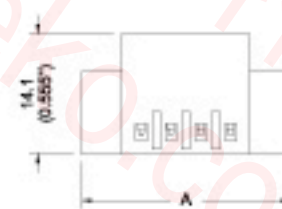
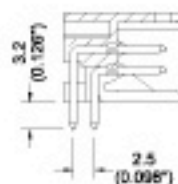
Item No.	A(mm)	A(inch)
ME950-35002	3.5	0.138
ME950-35004	7.0	0.276
ME950-35006	10.5	0.413
ME950-35008	14.0	0.551
ME950-35010	17.5	0.689
ME950-35012	21.0	0.827
ME950-35014	24.5	0.965
ME950-35016	28.0	1.102
ME950-35018	31.5	1.240
ME950-35020	35.0	1.378
ME950-35022	38.5	1.516
ME950-35024	42.0	1.654
ME950-35026	45.5	1.791
ME950-35028	49.0	1.929
ME950-35030	52.5	2.067
ME950-35032	56.0	2.205
ME950-35034	59.5	2.343
ME950-35036	63.0	2.480
ME950-35038	66.5	2.618
ME950-35040	70.0	2.756



PCB Layout

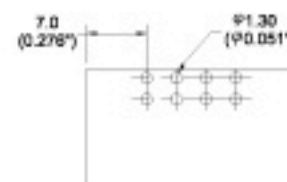

Pitch: 3.50mm(0.138inch)

- **Description :**
- Pitch : 3.50mm (0.138inch)

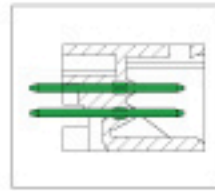

SPECIFICATIONS

			CUL
負載電壓	Rated Voltage	Bemessungsspannung	AC 150V
負載電流	Rated Current	Bemessungsstrom	5A
塑膠本體	Housing Material	Isolierstofftyp	Polyamide66(UL94V-0)
焊針	Solder Pin	Lötstift	□0.8mm, Brass, Tin plated
操作溫度	Operating Temperature	Umgebungstemperatur	-40°C to + 105°C
PC板孔徑	PCB Hole Diameter	Lochdurchmesser	φ1.3mm
UL File No.	E167040		

TABLE

Item No.	A(mm)	A(inch)
ME960-35002	14.80	0.583
ME960-35004	18.30	0.720
ME960-35006	21.80	0.858
ME960-35008	25.30	0.996
ME960-35010	28.80	1.134
ME960-35012	32.30	1.272
ME960-35014	35.80	1.409
ME960-35016	39.30	1.547
ME960-35018	42.80	1.685
ME960-35020	46.30	1.823
ME960-35022	49.80	1.961
ME960-35024	53.30	2.098
ME960-35026	56.80	2.236
ME960-35028	60.30	2.374
ME960-35030	63.80	2.512
ME960-35032	67.30	2.650
ME960-35034	70.80	2.787
ME960-35036	74.30	2.925
ME960-35038	77.80	3.063
ME960-35040	81.30	3.201

