

FLOATLESS RELAY  
液面控制器

AFR-1

DIMENSIONS(mm)  
尺寸

61H×49W×70D

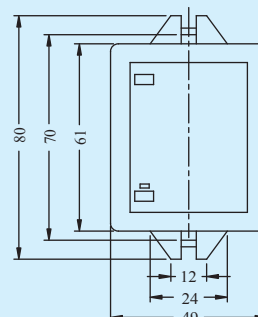

SOCKET TYPE  
底座型號

8PFA

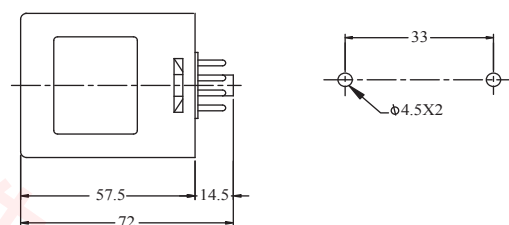
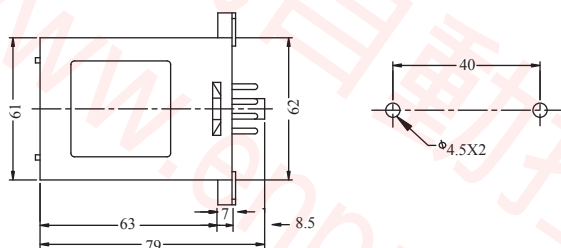

RATED VOLTAGE  
額定電壓 AC: 110V, 220V, 240V, 380V, 415V, 440V, 50/60Hz

AFR-1

INDICATOR OPERATING  
指示燈動作 Two LED'S use for two status  
兩只LED燈作狀況指示

OPERATING VOLTAGE  
動作電壓 85~110% of rated voltage  
額定電壓值的85~110%

SECOND VOLTAGE  
電極內電壓 8VAC(except HIGH SENSING 24VAC)

OPERATE RESISTANCE  
動作電阻 4KΩ min.(GENERAL)

RELEASE RESISTANCE  
釋放電阻 15KΩ min.(GENERAL)

RESPONSE TIME  
反應時間 Operate: 80 msec max .Release:160 msec max.  
動作: 80msec 以下,釋放: 160msec以下

CONTACT RATING  
接點容量 1C 5A,250VAC(resistive load)

LENGTH OF CABLE  
電纜長度 1Km max, (GENERAL)

L I 壽 MECHANICAL  
機械 5×10<sup>6</sup> times min

F E 命 ELECTRICAL  
電氣 10<sup>5</sup> times min

INSULATION RESISTANCE  
絕緣電阻 100MΩ (DC 500V) min.

DIELECTRIC STRENGTH  
耐電壓 1500VAC, 50/60Hz, for 1 minute

CONSUMED POWER  
消耗功率 3.2VA

AMBIENT TEMPERATURE  
使用周圍溫度 -10°C~ +55°C

AMBIENT HUMIDITY  
使用周圍濕度 45~85%RH

WEIGHT  
重量 200g

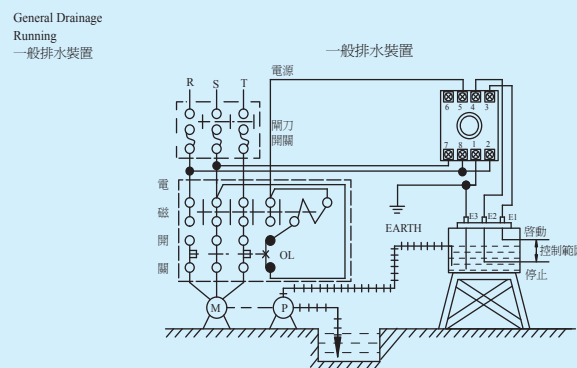
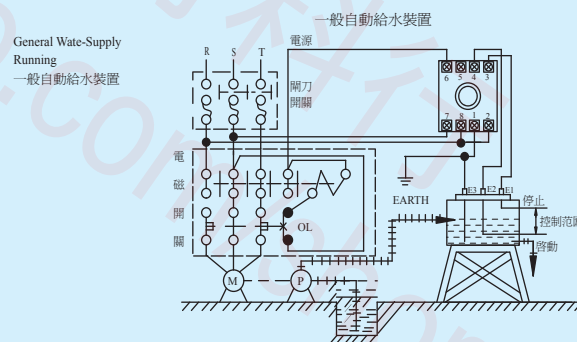

FLOATLESS RELAY

液面控制器

C61F-GP

DIMENSIONS(mm)  
尺寸

50H×40W×57.5D

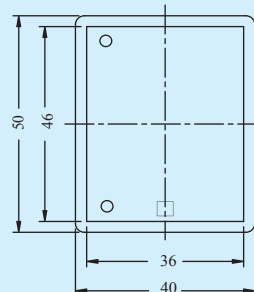

SOCKET TYPE  
底座型號

PF085A

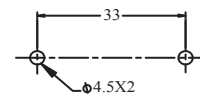
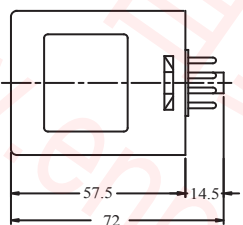

RATED VOLTAGE 額定電壓	AC: 110V, 220V, 240V, 380V, 415V, 440V, 50/60Hz	
INDICATOR OPERATING 指示燈動作	Two LED'S use for two status 兩只LED燈作狀況指示	
OPERATING VOLTAGE 動作電壓	85~110% of rated voltage 額定電壓值的85~110%	
SECOND VOLTAGE 電極內電壓	8VAC(except HIGH SENSING 24VAC)	
OPERATE RESISTANCE 動作電阻	4KΩ min.(GENERAL)	
RELEASE RESISTANCE 釋放電阻	15KΩ min.(GENERAL)	
RESPONSE TIME 反應時間	Operate: 80 msec max .Release:160 msec max. 動作: 80msec 以下,釋放: 160msec以下	
CONTACT RATING 接點容量 1C	5A,250VAC(resistive load)	
LENGTH OF CABLE 電纜長度	1Km max, (GENERAL)	
L I F E 壽命	MECHANICAL 機械	5×10 <sup>6</sup> times min
	ELECTRICAL 電氣	10 <sup>5</sup> times min
INSULATION RESISTANCE 絕緣電阻	100MΩ (DC 500V) min.	
DIELECTRIC STRENGTH 耐電壓	1500VAC, 50/60Hz, for 1 minute	
CONSUMED POWER 消耗功率	3.2VA	
AMBIENT TEMPERATURE 使用周圍溫度	-10℃~+55℃	
AMBIENT HUMIDITY 使用周圍濕度	45~85%RH	
WEIGHT 重量	160g	

C61F-GP

General Water-Supply  
Running  
一般自動給水裝置

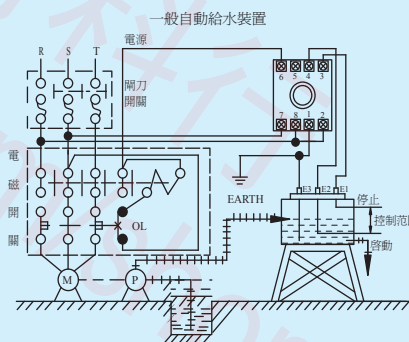

General Drainage  
Running  
一般排水裝置

